



# PROMETHEUS

## SOFTWARE



What do we do?

Consulting is just the start!



---

## About us

---

The principals of Prometheus have been technology entrepreneurs since their founding of Baldhead Systems in 1994. Prometheus Software provides customers with a suite of services, including software design and development, systems integration, network support, IT consulting, professional services and project management.

Current projects include integrating A.I. with Computer Vision to re-invent the way cameras are deployed in security applications, manufacturing processes and traffic management.

Some of the principals' biggest achievements include being the first to create a secure mobile banking application and the first to create a real-time mobile stock trading application for Blackberry, Palm and Pocket PC when, in 2000, a partnership was forged with the Royal Bank of Canada to form a new company called Sona Innovations Inc. This venture was a result of the partners forward thinking and innovative ideas.

# What We Do



## Design

Design is crucial to a project's success. We work with you to define a strategic design that achieves your objectives.



## Develop

Execution is everything. We have the resources to carry out your plan and we don't off-shore any of our work!



## Deploy

Ready? Set? GO! With your project ready to go live we make sure it is tested & ready for primetime.



## Support

Let Prometheus support and maintain your applications, saving your valuable time and resources. If we touch it, we can support it

# Consulting

"Prometheus offers Operations and Process Consulting as well as pure technical assistance and support. We are engineers and developers who understand business processes."

*- Michel Beaulieu, CFO & VP Operations*

"We can help with the 'how' but we can also help develop the 'what'."

*- Duncan Brown, CTO*

"Understanding a client's situation and even helping a client to understand their situation is just as vital as any development work."

*- Korie Ocolisan, Customer Relations*

"We can engage stakeholders at any level in an enterprise's hierarchy, develop a strong working relationship with them, assess their needs as well as their current situation, and develop a plan on how best to address those needs. And, unlike other consultancies, we are also able to execute most if not all of those plans."

*- Jay Jordon, CEO*

## Challenge us with your issues.

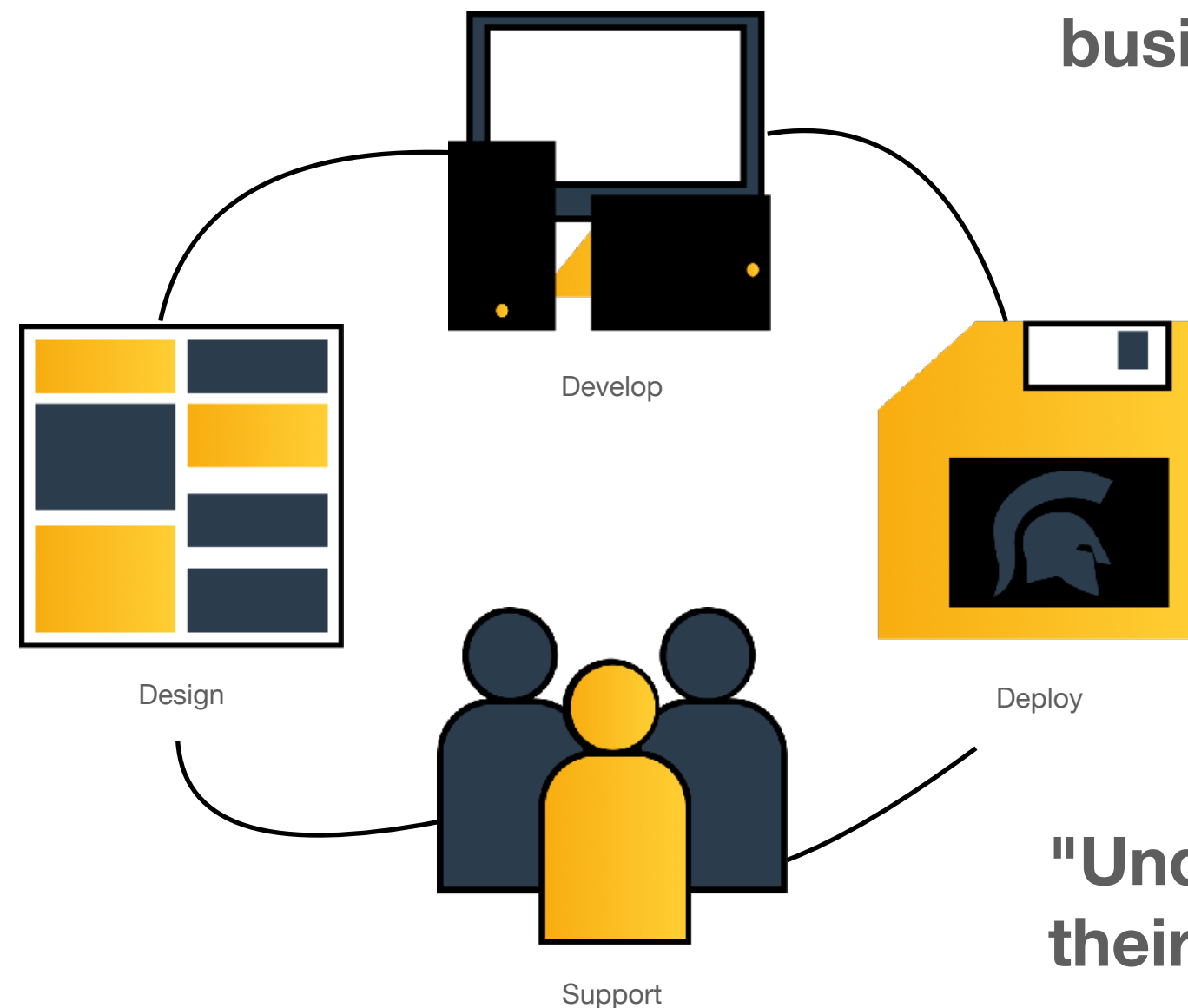

# Systems Administration and Technical Support



Prometheus Software understands business, at our core we are operators. We offer more than basic Systems Administration and Tech Support. We solve real-life business problems in efficient ways. We make sure you have the right tools to improve your:

- Data security
- Server maintenance
- Workstation maintenance
- Web presence
- Web responsiveness
- Clunky hardware
- And so much more!

We'll analyze your systems, daily operations, and your human resources.

Together, we

- Define your corporate goals
- Learn how much I.T. affects productivity
- Discover security loopholes
- Find industry-specific I.T. solutions for your requirements



---

# Mobile Applications

---

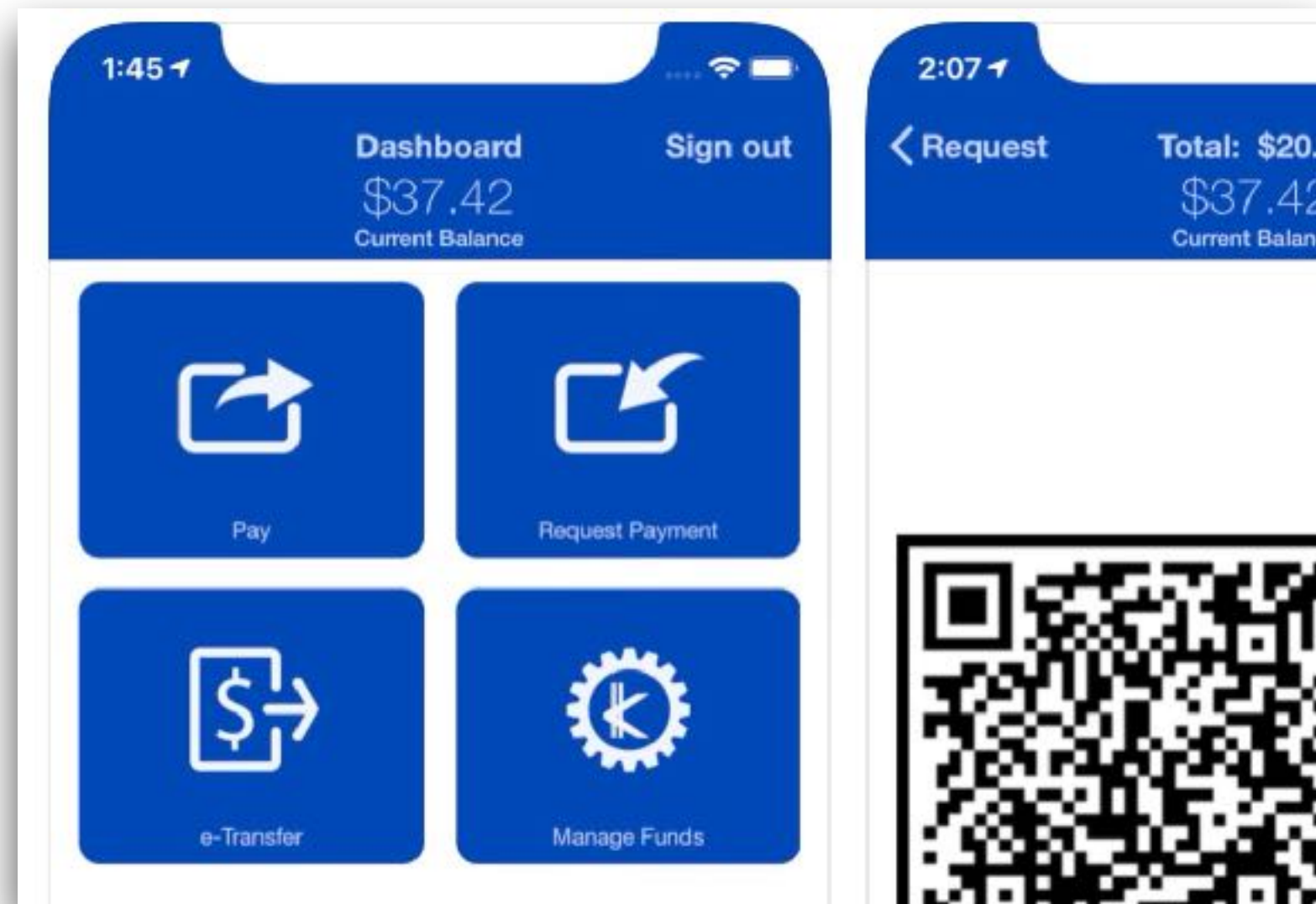

The Prometheus team are leaders in the development and deployment of mobile applications. Our team is at the forefront of the mobile space, developing many first-to-market applications.

Whatever the challenge, Prometheus can make it happen.

Mobile applications can be designed for any audience, with use cases including (but not limited to) inventory management, security, and customer service. Incorporating the latest developments in A.I. and Computer Vision can also be accomplished.

Other consumer mobile applications include e-commerce, marketing, entertainment and communication. Trust us to develop an app that exceeds you and your customers' expectations.

Our in house payment application, Kaching Pay, for smartphones is the jumping-off point for white label payment systems, incorporating:

- iOS and Android platforms
- QR code technology
- Multiple currencies
- Full integration with multiple payment rails
- Transactions verified and completed instantly
- And so much more!

---

# Systems Integration and Professional Services

---



The primary reason why businesses integrate with other systems is to boost productivity and enhance the quality of day-to-day operations.

Bringing together different software components and sub-systems helps accelerate the outflow of information and cut back on operational costs.

Proper and efficient use of technology affords businesses the possibility to make it to that next level which, in the past, was only possible with a great expansion of human resources.

The same principle applies to maintaining the desired level of productivity while maximizing human resources.

Prometheus Software has, over the years, helped its clients take that leap forward towards great expansion while improving overall profitability, including limiting the inflation of human resources that typically results from rapid growth.



---

# Artificial Intelligence (AI) and Computer Vision

---



Computer Vision enables solutions that can process far more than the human eye can in terms of volume, complexity and speed.

Artificial Intelligence is the development of machines and software that can perform tasks typically requiring human intelligence.

Combined, these solutions supercharge technology. Machine performance becomes fast and accurate, far outperforming any amount of manual effort. Not only are reaction times greatly improved, but solutions can be made predictive, tailored to any desired domain.

Technology should fit the business—not the other way around.

Prometheus Software brings to the table a wealth of experience in systems integration as well as Computer Vision and Artificial Intelligence development, leveraging the latest advancements in equipment and technology.

Incorporating industry-leading hardware, Prometheus Software provides scalable solutions built to address unique business problems across myriad verticals, using both bespoke and COTS\*-based platforms.

\*Commercial Off The Shelf



# Our Clients

